

EE、EFコア

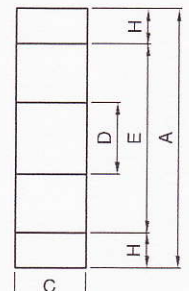
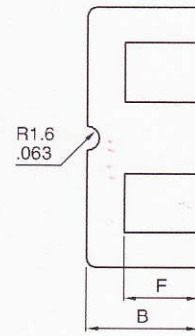
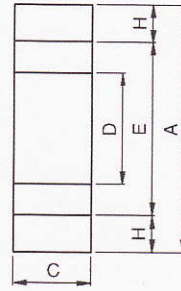
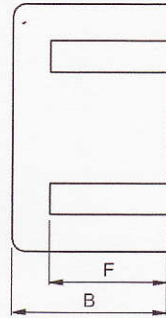
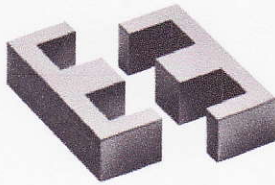
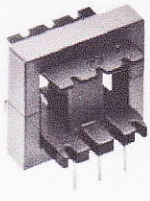

Type 1

Type 2

| 品名 | U.S. lam. cores, DIN standard JIS | Type | 寸法 (mm) | | | | | | |
|-----------------|---|------|------------|-----------|-----------|-----------|--------|-------------|------|
| | | | A | B | C | D | E min. | F | H |
| PC40EE8-Z | JIS FEE 8.3 | 1 | 8.3±0.2 | 4.0±0.1 | 3.6±0.2 | 1.85±0.15 | 6.0 | 3.0±0.1 | 1.0 |
| PC40EE10/11-Z | JIS FEE 10.2 | 1 | 10.2±0.2 | 5.5±0.1 | 4.75±0.15 | 2.45±0.15 | 7.7 | 4.20±0.15 | 1.1 |
| PC40EF12.6-Z | DIN 41985 | 1 | 12.7±0.4 | 6.4±0.1 | 3.6±0.2 | 3.65±0.15 | 8.8 | 4.65±0.15 | 1.83 |
| PC40EE13-Z | | 1 | 13.0±0.2 | 6.00±0.15 | 6.15±0.15 | 2.75±0.15 | 10.0 | 4.6±0.1 | 1.4 |
| PC40EE16-Z | JIS FEE 16A | 1 | 16.0±0.3 | 7.15±0.15 | 4.8±0.2 | 4.0±0.2 | 11.7 | 5.1±0.2 | 2.0 |
| PC40SEE16-Z | | 1 | 16.0±0.3 | 7.15±0.15 | 6.8±0.2 | 3.18±0.18 | 12.5 | 5.5±0.1 | 1.6 |
| PC40EF16-Z | DIN 41985 | 1 | 16.1±0.6 | 8.05±0.15 | 4.5±0.2 | 4.55±0.15 | 11.3 | 5.9±0.2 | 2.2 |
| PC40EE19-Z | JIS FEE 19A | 1 | 19.1±0.3 | 7.95±0.15 | 5.0±0.2 | 4.55±0.15 | 14.2 | 5.6±0.1 | 2.3 |
| PC40EE19/16-Z | U.S. EE-187 | 1 | 19.29±0.32 | 8.1±0.18 | 4.75±0.13 | 4.75±0.08 | 14.05 | 5.715±0.125 | 2.46 |
| PC40EE20/20/5-Z | DIN 41295 | 2 | 20.15±0.55 | 10.0±0.2 | 5.1±0.2 | 5.0±0.2 | 12.8 | 6.5±0.2 | 3.53 |

| 品名 | パラメータ | | | | 電気的特性 | | コアロス (W) max. 100kHz, 200mT, 100°C | 質量 (g) | ボビン |
|-----------------|--|--|----------------------------------|---|--|-------------------|--|-----------|---|
| | コア定数 C _i (mm ⁻¹) | 実効 断面積 A _e (mm ²) | 実効 磁路長 ℓ _e (mm) | 実効体積 V _e (mm ³) | AL-value (nH/N ²) [*] | | | | |
| | | | | | ギャップなし | ギャップ付 | | | |
| PC40EE8-Z | 2.75 | 7.0 | 19.2 | 134 | 610±25% | 40±7% 63±10% | 0.06 | 0.7 | BE8-116CPHFR |
| PC40EE10/11-Z | 2.16 | 12.1 | 26.1 | 315 | 850±25% | 40±7% 63±10% | 0.14 | 1.5 | BE10-118CPSFR |
| PC40EF12.6-Z | 2.28 | 13.0 | 29.6 | 385 | 810±25% | 63±7% 100±10% | 0.17 | 2.0 | — |
| PC40EE13-Z | 1.77 | 17.1 | 30.2 | 517 | 1130±25% | 63±7% 100±10% | 0.235 | 2.7 | BE13-1110CPSFR |
| PC40EE16-Z | 1.82 | 19.0 | 34.5 | 656 | 1140±25% | 80±7% 160±10% | 0.31 | 3.3 | BE16-116CPFR BE16-118CPHFR BE16-1110CPNFR |
| PC40SEE16-Z | 1.69 | 21.7 | 36.6 | 795 | 1240±25% | 80±7% 160±10% | 0.37 | 4.1 | BES16-1110CPSFR |
| PC40EF16-Z | 1.87 | 20.1 | 37.6 | 754 | 1100±25% | 63±7% 100±10% | 0.32 | 3.9 | — |
| PC40EE19-Z | 1.71 | 23.0 | 39.4 | 906 | 1250±25% | 80±7% 160±10% | 0.42 | 4.8 | BE19-116CPFR BE19-118CPHFR BE-19-5116 |
| PC40EE19/16-Z | 1.75 | 22.4 | 39.1 | 876 | 1350±25% | 80±7% 160±10% | 0.41 | 4.8 | — |
| PC40EE20/20/5-Z | 1.38 | 31.0 | 43.0 | 1340 | 1400±25% | 100±7% 160±10% | 0.51 | 7.5 | — |

* AL-value: 1kHz, 0.5mA, 100Ts